

CT80II ABR

Electric Energy Measurement for Remote Management in Low Voltage

SPLIT CORE CURRENT TRANSFORMERS

- Transformer ratio 1200/5.
- Sealable plastic cover, fixing base and bus-bar.
- Certificate model for pricing.

Primary .../ 5A	Model	Code	VA class
1200	CT80II ABR	41441	0,5 5

CHARACTERISTICS

Overload	1,5 I_N
Frequency	50/60 Hz
Short circuiting terminal blocks for opensecondary	YES
Maximum voltage secondary open	48 V
Maximum Voltage U_m	0,72 kV
Isolation voltage	3 kV
Short circuit thermal current I_{th}	72 kA
Short circuit dynamic current I_{dyn}	2,5 x I_{th}
Accuracy limit	150 %
Security factor	5
Insulation class	E

STANDARDS

UNE-EN 60 044-1 (8.1, 11.7, 12.7) Terminal marking and nameplate
UNE-EN 60 044-1 (7.1) Short circuit
UNE-EN 60 044-1 (7.2) Heating test
UNE-EN 60 044-1 (11.4) Determination of errors
UNE-EN 60695-2-11 Glow wire test

ADMISSIBLES STEPS

1x240, 2x240, 1x300, 2x300 (terminals included)	Suitable
Bar 80x50	Suitable

CT80II ABR



Sealable plastic cover



CE

INDIVIDUAL TESTS

UNE-EN 60 044-1 (8.1, 11.7, 12.7) Terminal marking and nameplate
UNE-EN 60 044-1 (5.3) Frequency withstand volt. between secondary windings
UNE-EN 60 044-1 (8.4) Overvoltage tests between turns
UNE-EN 60 044-1 (11.4, 11.5) Determination of errors

DIMENSIONS CT (mm)

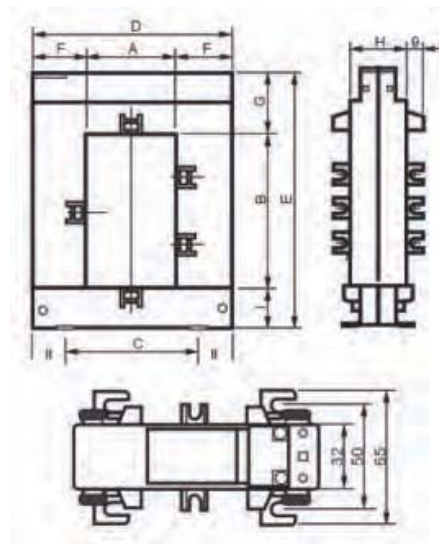

mm	CT80II EXT
A	50
B	80
C	78
D	114
E	145
F	32
G	32
H	32
I	33